

# Wind Speed Sensor

WSM 101/4-20 mA

## TECHNICAL DATA

Wind speed measurement range:	0,8 - 50,0 m/s
Operating voltage:	9...30 V DC
Signal output:	4...20 mA, 2 wire 4 mA = 0 m/s 20 mA = 50 m/s
Output averaging period:	1 s
Resolution:	0,1 m/s
Loop resistance:	max. 600Ω /24V
Reverse polarity protection:	YES
Transient voltage protection:	YES
Temperature Operating Range:	-25 ... +60 °C
Relative Humidity:	0 ... 100%
Accuracy:	+/- 4 %
Cable:	2 x 0,34 mm <sup>2</sup> ; 5 m standard
Bearings:	2 x precision stainless steel Ball bearing
Material	housing: PE cups (replacable): PA
Mounting :	the sensor mounts on a pipe with $\varnothing$ 27 mm outside diameter

## WIRING

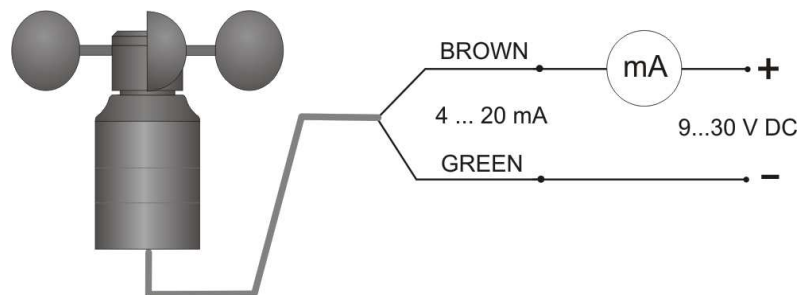

## DIMENSIONS

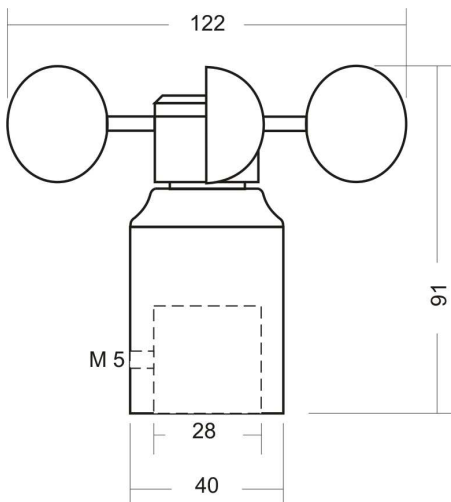

## OUTPUT

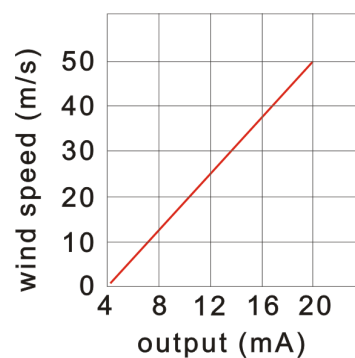

Subject to technical modification without notice.